

## TOP



COMFORT

**EXPEDIA** chair for ENT with robust structure and elegant design. Structure in high quality steel painted with epoxy powder with antimicrobial characteristics. Basement is leaning against on the floor and covered with a rounded abs casing. High load capacity: 180kg. The armrests are made of integral light gray polyurethane and they are also removable. The upholstery is made of class 1 IM fireproof sky, antibacterial, antifungal, disinfectable and resistant to wear. Equipped with foldaway footrest. It is available in two versions: BASIC and TOP. The lift is electrically operated with a low voltage motor (24V-DC) in both versions. In the BASIC version the backrest can be reclined up to the bed position and the movement is controlled by a gas spring which can be locked in the desired position while the leg rest is fixed at 90 ° with respect to the seat and has a footrest.

The TOP version can also be used as a multifunctional chair because the additional equipment of the electric backrest and leg rest movement is also suitable for small outpatient surgical operations because thanks to the synchronized movement of the leg rest and backrest, the chair is transformed

into a bed allowing to the doctor to carry out the diagnosis to completely distended patient. The leg rest is equipped with a retractable footrest and is padded and covered in sky.

In both versions the seat can be rotated through 180° (90° on the right and 90° on the left) and locking and unlocking are carried out manually with a mechanical system.

The electric controls are managed by foot control for the BASIC version while on the TOP version a push-button control is also available.

Numerous accessories are available (see accessories list) to make the product more functional.

# CARATTERISTICHE TECNICHE TECHNICAL FEATURES

Tensione di alimentazione  
Tension/Frequency  
**230V-50Hz**

Motori bassa tensione  
Low-voltage motors  
**24 V-DC**

Capacità di sollevamento  
Lifting capacity  
**180 Kg**

Grado di protezione  
Degree protection  
**IP54**

Peso della poltrona  
Chair weight  
**94 kg**

Seduta ruotabile  
**90°dx / 90° sx**  
Rotatable seat  
**90° right and 90° left**

**TOP**



**BASIC**



<b>A.</b>	<b>545 mm</b>
<b>B.</b>	<b>210 mm</b>
<b>C.</b>	<b>1375 mm</b>
<b>D.</b>	<b>920 mm</b>

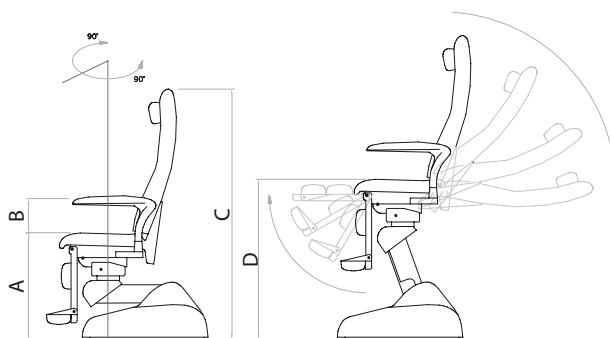

## ACCESSORI\_OPTIONALS

### EP06

Asta portaflebo 2 ganci

I.V. Stand with 2 hooks – Drip holder stand



### E04

Poggiatesta ad altezza regolabile

Adjustable height headrest



12500010

#### Funzione Memory Position:

##### permette la memorizzazione di 4 posizioni

- 2 preimpostate dalla casa: CPR e posizione iniziale di visita (gestite da comando a pulsantiera)
- 2 posizioni di trattamento programmabili autonomamente dal medico (gestite da comando a pedale con tecnologia wireless)

Gestione movimentazioni elettriche tramite comando a pulsantiera e comando a pedale con tecnologia wireless.



#### Memory Position Function:

##### it allows the memorization of 4 positions

- 2 positions are preset by the firm: CPR and the initial position of the medical examination (they are managed by a push-button control)
- 2 positions are set freely by the doctor (a foot switch with wireless technology manages them)

The management of the electrical movements is organized through a foot switch with wireless technology

## CARTELLA COLORI - COLOURS CHART

2DO	8H1	8H8	6KO	7FI	6KN	4L1
7FG	3CT	5H7	5HK	5HL	5HJ	41A
7FE	7ES	5HH	4I3	4HI	4HG	101
901	2DL	2EC	8HE	2E5	8H6	6M5
6MC						

Tappezzeria realizzata rigorosamente con l'utilizzo di materiale con caratteristiche antibatteriche ed antimicotiche; materiale ignifugo e con alta resistenza all'abrasione.

Upholstery made strictly with the use of materials with antibacterial and antimycotic properties; fireproof material and with high abrasion resistance

**7/TT Med<sup>®</sup>**